

CAMPUS @ BAYSIDE

FREMONT, CA



AVAILABLE FOR LEASE
6 ADVANCED MANUFACTURING BUILDINGS

473,250 SF
(TOTAL COMBINED)



PROJECT FEATURES

- ▶ Master Planned Business Park (Bayside)
- ▶ Six (6) Freestanding Advanced Manufacturing Buildings
- ▶ 4,000 Amps @ 480V per Building (except Building 4)
- ▶ 473,250 Total Square Feet
- ▶ Enhanced Entry and Window Line
- ▶ EV Charging Stations Throughout the Park
- ▶ Multiple Dock and Grade Loading
- ▶ ESFR Sprinkler System
- ▶ Easy Access to I-880, I-680 and 237



BUILDING 1

101,600 SF (EXPANDABLE TO 104,600 SF)

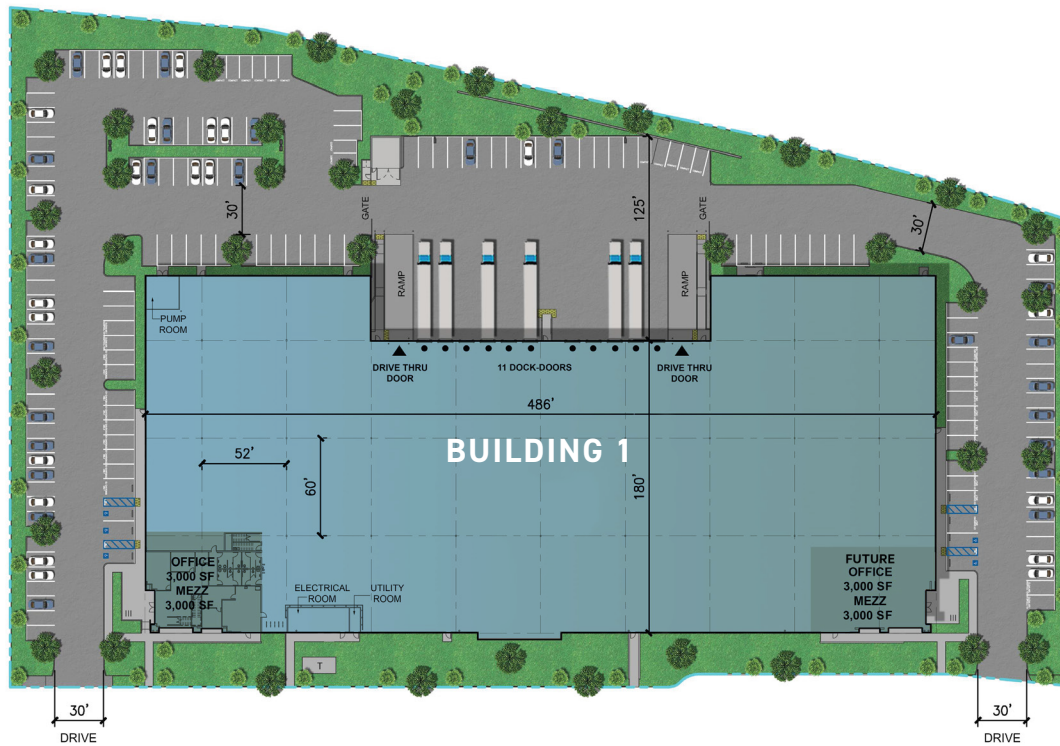

● DOCK HIGH DOORS

▲ GRADE LEVEL

BUILDING 1	101,600 SF (EXPANDABLE TO 104,600 SF)
OFFICE SF	6,000 SF SPEC / Expandable to 12,000 SF
CLEAR HEIGHT	32' Minimum
COLUMN SPACING	52' x 60'
POWER	4,000 Amps @ 277/480V
PARKING	186 Parking Stalls (1.6/1,000)
EV CHARGING STATIONS	19
LOADING	11 Dock High/ 2 Grade Level
SLAB THICKNESS	6"
SPRINKLERS	ESFR
TRUCK COURT	125'



BUILDING 2

74,913 SF

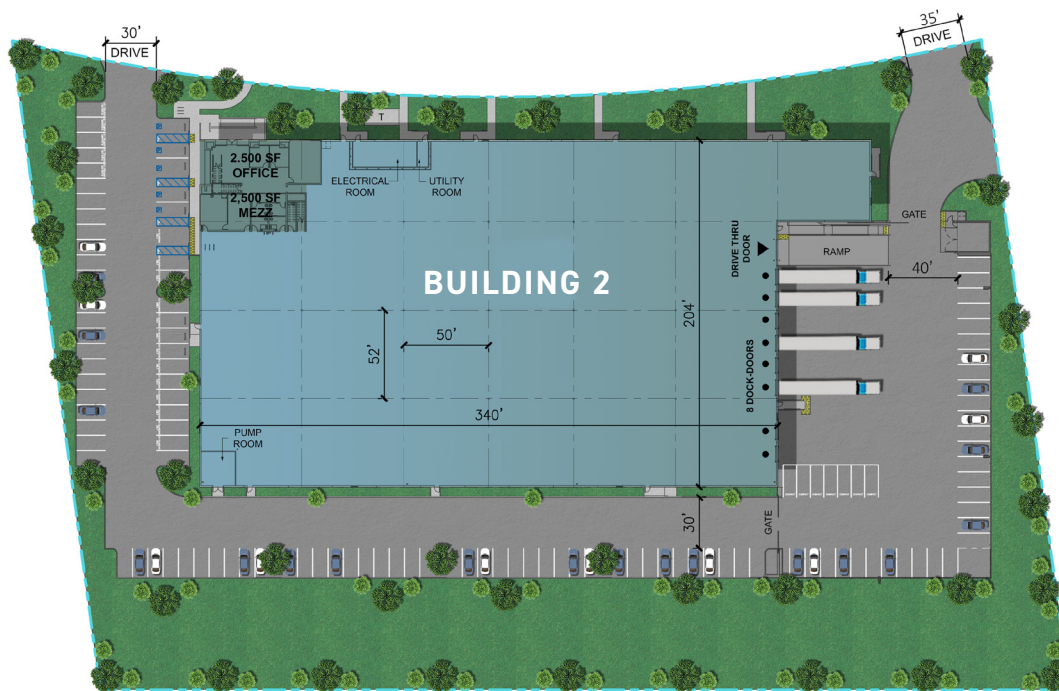

● DOCK HIGH DOORS

▲ GRADE LEVEL

BUILDING 2	74,913 SF
OFFICE SF	5,020 SF
CLEAR HEIGHT	32' Minimum
COLUMN SPACING	50' x 52' and 60' x 52'
POWER	4,000 Amps @ 277/480V
PARKING	120 Parking Stalls (1.6/1,000)
EV CHARGING STATIONS	13
LOADING	8 Dock High/ 1 Grade Level
SLAB THICKNESS	6"
SPRINKLERS	ESFR
TRUCK COURT	125'



BUILDING 3

76,959 SF (EXPANDABLE TO 78,959 SF)

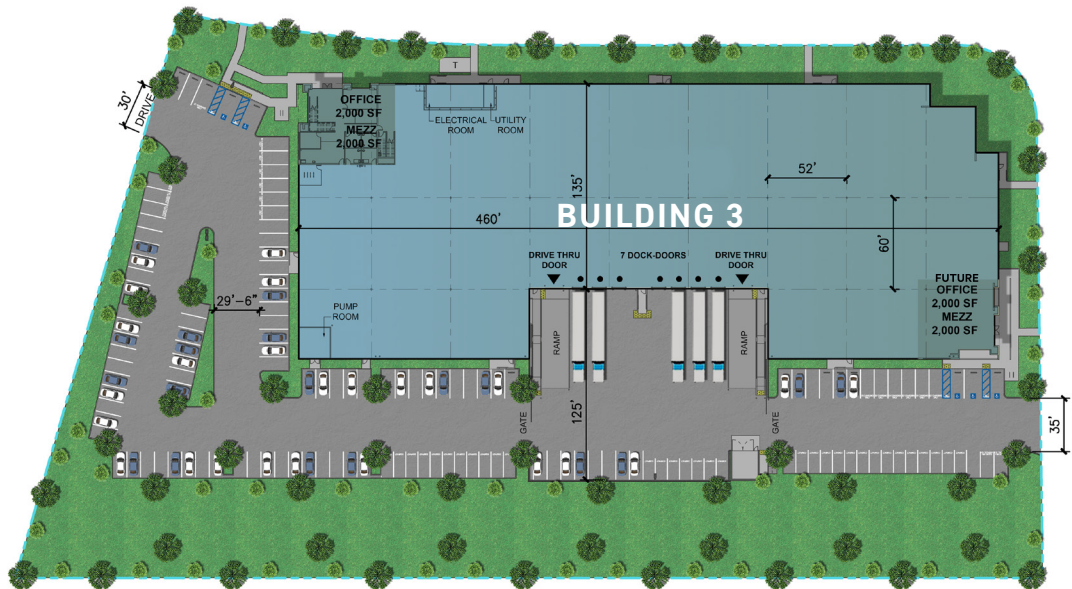

● DOCK HIGH DOORS

▲ GRADE LEVEL

BUILDING 3	76,959 SF (EXPANDABLE TO 78,959 SF)
OFFICE SF	4,000 SF Spec / Expandable to 8,000 SF
CLEAR HEIGHT	32' Minimum
COLUMN SPACING	Varies: 52' x 75', 52' x 59'7", 52' x 46'5"
POWER	4,000 Amps @ 277/480V
PARKING	129 Parking Stalls (1.6/1,000)
EV CHARGING STATIONS	13
LOADING	7 Dock High/ 2 Grade Level
SLAB THICKNESS	6"
SPRINKLERS	ESFR
TRUCK COURT	125'



BUILDING 4

38,593 SF

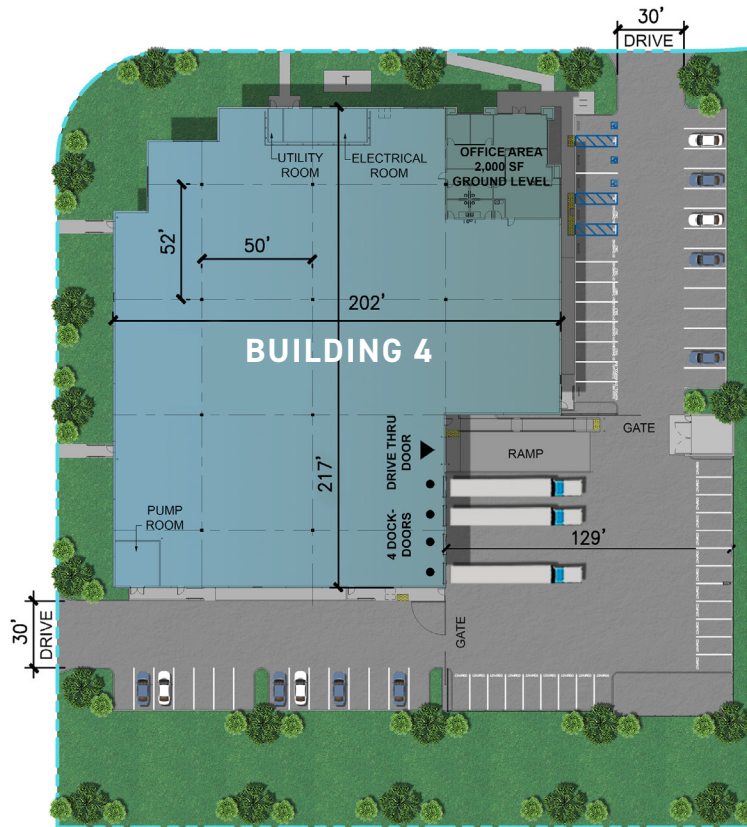

● DOCK HIGH DOORS

▲ GRADE LEVEL

BUILDING 4	38,593 SF
OFFICE SF	2,054 SF
CLEAR HEIGHT	30' Minimum
COLUMN SPACING	50' x 52' (Varies)
POWER	1,600 Amps @ 277/480V
PARKING	65 Parking Stalls (1.6/1,000)
EV CHARGING STATIONS	7
LOADING	4 Dock High/ 1 Grade Level
SLAB THICKNESS	6"
SPRINKLERS	ESFR
TRUCK COURT	129'



BUILDING 5

85,019 SF

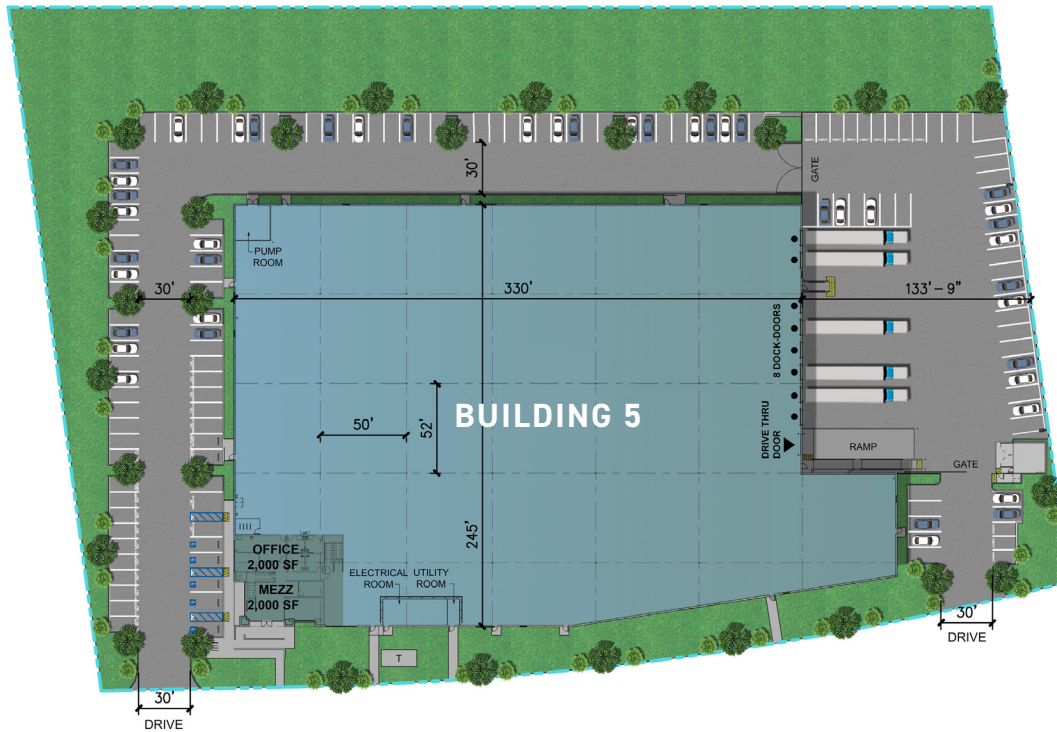

● DOCK HIGH DOORS

▲ GRADE LEVEL

BUILDING 5	85,019 SF
OFFICE SF	4,000 SF
CLEAR HEIGHT	32' Minimum
COLUMN SPACING	50' x 52' and 60' x 52'
POWER	4,000 Amps @ 277/480V
PARKING	137 Parking Stalls (1.6/1,000)
EV CHARGING STATIONS	13
LOADING	8 Dock High/ 1 Grade Level
SLAB THICKNESS	6"
SPRINKLERS	ESFR
TRUCK COURT	128'2" - 143'5"



BUILDING 6

87,183 SF (EXPANDABLE TO 89,683 SF)

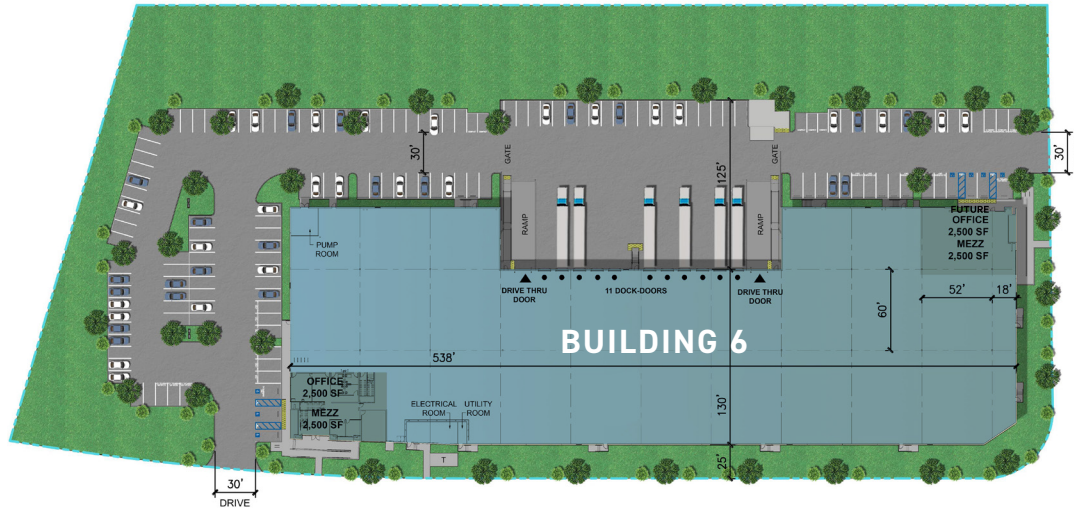

● DOCK HIGH DOORS

▲ GRADE LEVEL

BUILDING 6	87,183 SF (EXPANDABLE TO 89,683 SF)
OFFICE SF	5,000 SF SPEC/ Expandable to 10,000 SF
CLEAR HEIGHT	32' Minimum
COLUMN SPACING	52' x 59'7" and 52' x 70"
POWER	4,000 Amps @ 277/480V
PARKING	150 Parking Stalls (1.6/1,000)
EV CHARGING STATIONS	13
LOADING	11 Dock High/ 2 Grade Level
SLAB THICKNESS	6"
SPRINKLERS	ESFR
TRUCK COURT	125'



AMENITY MAP



**CAMPUS
@ BAYSIDE**
FREMONT, CA

THE MAD FIT
SportClips
HAIRCUTS
CHASE

IN-N-OUT
BURGER

FIREHOUSE
SUBS

PEARL BAY
RESTAURANT

COSTCO
WHOLESALE

LOWE'S

MEN'S WEARHOUSE
AT **Krispy Kreme**
DOUGHNUTS **BUFFALO WILD WINGS**

COLD STONE
CREAMERY **jamba**
dish dash Market Broker
TO GO! RESTAURANTS
CITI **rack** **OLD NAVY**
KOHL'S FIVE GUYS

SUBWAY
99 RANCH MARKET
STARBUCKS **jamba**
H&R BLOCK **CVS** **Jack**
pharmacy in the box

McDonald's

MARRIOTT **LA QUINTA**
BY WYNDHAM

Hampton **Bay Club** **HYATT PLACE**

COURTYARD
BY MARRIOTT

680

880

880

680

880

ROUND TABLE
PIZZA ROYALTY **7 ELEVEN**

Valero

extended
STAY AMERICA

BANK OF AMERICA
SAFeway **USPS.COM** **76**
STARBUCKS

76

UPS

WELLS FARGO **BOILING POINT** **happyjeron**

FREMONT GALLERIA
7 ELEVEN **KAZUMA SUSHI**
Sala Thai **HOCHOW**

Walmart

RHL

Walgreens

McDonald's **LION MARKET** 獅子城

CORPORATE NEIGHBORS MAP



CAMPUS @ BAYSIDE

FREMONT, CA



CONTACT INFO

THOMAS TAYLOR

Executive Vice President
Lic. 00944083
T +1 408 453 7417
C +1 408 828 1898
thomas.taylor@cbre.com

MATTHEW TAYLOR

Executive Vice President
Lic. 01897355
T +1 408 453 7469
C +1 408 221 1735
matthew.taylor@cbre.com

DOUGLAS NORTON

Senior Vice President
Lic. 00851808
T +1 949 725 8511
C +1 925 818 1930
doug.norton@cbre.com

ROBBIE TAYLOR

First Vice President
Lic. 01946325
T +1 408 453 7489
C +1 408 218 0525
robbie.taylor2@cbre.com

MIKE NORTON

Associate
Lic. 02030025
T +1 949 725 8522
C +1 925 360 7947
mike.norton@cbre.com