

# CAMPUS @ BAYSIDE

FREMONT, CA



AVAILABLE FOR LEASE  
**3 ADVANCED MANUFACTURING BUILDINGS**

**213,295 SF**  
(PHASE 2)



# PROJECT FEATURES

- ▶ Master Planned Business Park (Bayside)
- ▶ Six (6) Freestanding Advanced Manufacturing Buildings with Bldgs 1-3 in Phase 1 & Bldgs 4-6 in Phase 2
- ▶ Building 4: 2,000 Amps @ 480V  
Building 5: 4,000 Amps @ 480V  
Building 6: 4,000 Amps @ 480V
- ▶ 466,767 Total Square Feet
  - ▶ 253,472 SF in Phase 1 & 213,295 SF including Future Mezz at Bldg 6 in Phase 2
- ▶ Enhanced Entry and Window Line
- ▶ EV Charging Stations Throughout the Park
- ▶ Multiple Dock and Grade Loading
- ▶ ESFR Sprinkler System
- ▶ Easy Access to I-880, I-680 and SR-237



# BUILDING 4

38,593 SF

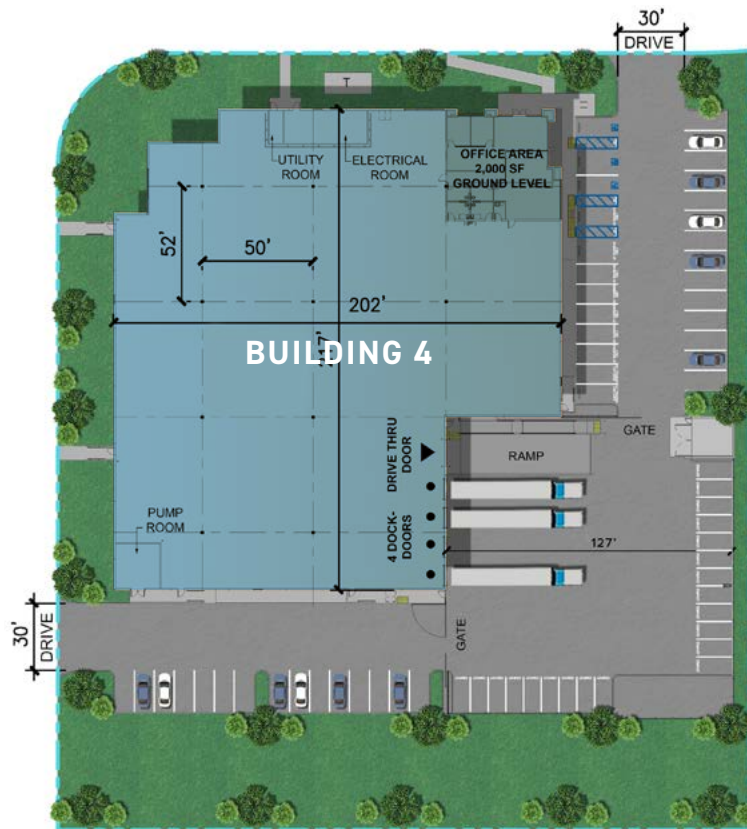

● DOCK HIGH DOORS

▲ GRADE LEVEL

<b>BUILDING 4</b>	<b>38,593 SF</b>
<b>OFFICE SF</b>	2,054 SF
<b>CLEAR HEIGHT</b>	30' Minimum
<b>COLUMN SPACING</b>	50' x 52' (Varies)
<b>POWER</b>	2,000 Amps @ 277/480V
<b>PARKING</b>	60 Auto Parking Stalls (1.6/1,000)
<b>EV CHARGING STATIONS</b>	8
<b>LOADING</b>	4 Dock High/ 1 Grade Level
<b>SLAB THICKNESS</b>	6" Reinforced
<b>SPRINKLERS</b>	K17 ESFR
<b>TRUCK COURT</b>	127'
<b>% SKYLIGHTS</b>	2.5%
<b>LED LIGHTING</b>	SPEC 20 FC in Warehouse
<b>DELIVERY DATE</b>	TBD



# BUILDING 5

85,019 SF

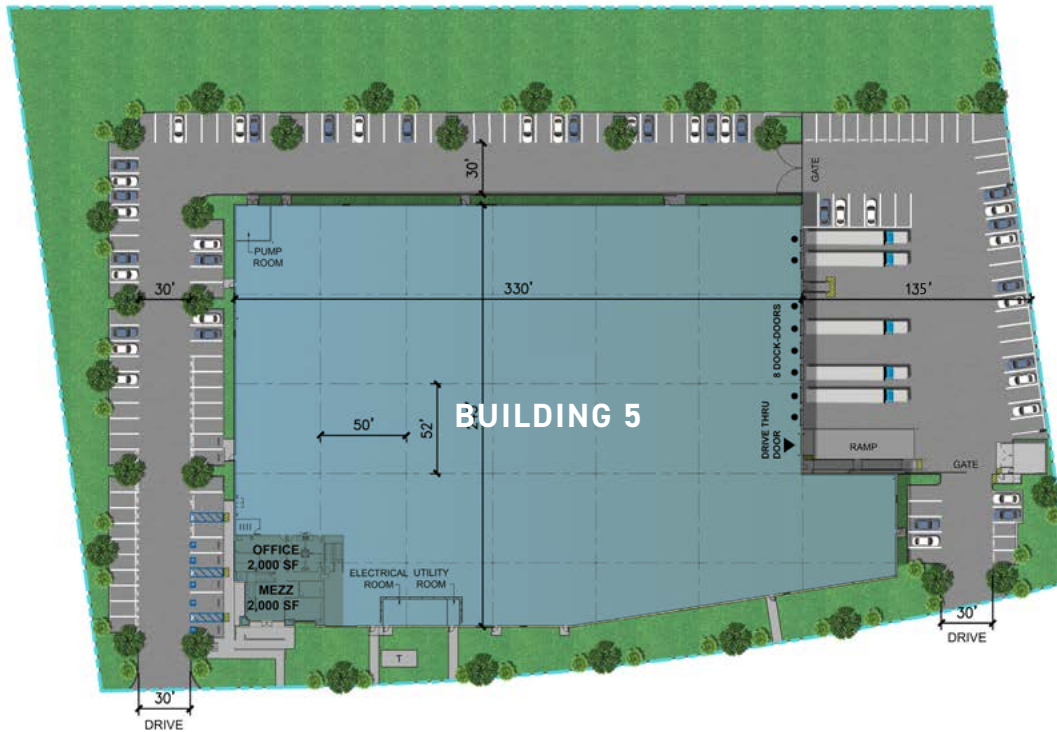

● DOCK HIGH DOORS

▲ GRADE LEVEL

BUILDING 5	85,019 SF
OFFICE SF	4,000 SF
CLEAR HEIGHT	32' Minimum
COLUMN SPACING	50' x 52' and 60' x 52'
POWER	4,000 Amps @ 277/480V
PARKING	138 Auto Parking Stalls (1.6/1,000)
EV CHARGING STATIONS	12
LOADING	8 Dock High/ 1 Grade Level
SLAB THICKNESS	6"
SPRINKLERS	K17 ESFR
TRUCK COURT	128'2" - 143'5"
% SKYLIGHTS	2.5%
LED LIGHTING	SPEC 20 FC in Warehouse
DELIVERY DATE	TBD



# BUILDING 6

87,183 SF (EXPANDABLE TO 89,683 SF)

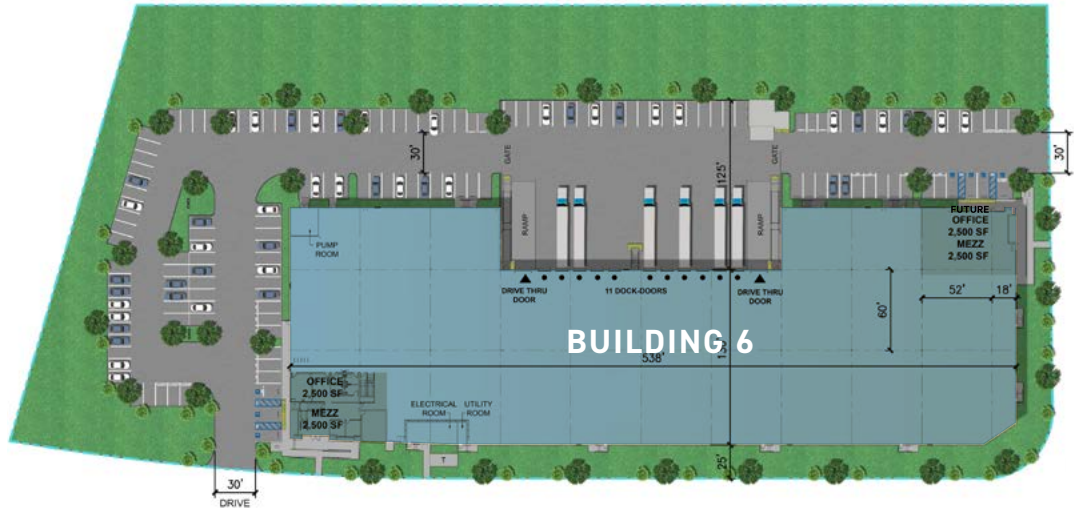

● DOCK HIGH DOORS

▲ GRADE LEVEL

<b>BUILDING 6</b>	<b>87,183 SF (EXPANDABLE TO 89,683 SF)</b>
<b>OFFICE SF</b>	5,000 SF SPEC/ Expandable to 10,000 SF
<b>CLEAR HEIGHT</b>	32' Minimum
<b>COLUMN SPACING</b>	52' x 59'7" and 52' x 70"
<b>POWER</b>	4,000 Amps @ 277/480V
<b>PARKING</b>	150 Auto Parking Stalls (1.6/1,000)
<b>EV CHARGING STATIONS</b>	11
<b>LOADING</b>	11 Dock High/ 2 Grade Level
<b>SLAB THICKNESS</b>	6"
<b>SPRINKLERS</b>	K17 ESFR
<b>TRUCK COURT</b>	125'
<b>% SKYLIGHTS</b>	2.5%
<b>LED LIGHTING</b>	SPEC 20 FC in Warehouse
<b>DELIVERY DATE</b>	TBD



# AMENITY MAP





# CAMPUS @ BAYSIDE

FREMONT, CA



## CONTACT INFO

### THOMAS TAYLOR

Executive Vice President  
Lic. 00944083  
T +1 408 453 7417  
C +1 408 828 1898  
thomas.taylor@cbre.com

### MATTHEW TAYLOR

Executive Vice President  
Lic. 01897355  
T +1 408 453 7469  
C +1 408 221 1735  
matthew.taylor@cbre.com

### DOUGLAS NORTON

Senior Vice President  
Lic. 00851808  
T +1 949 725 8511  
C +1 925 818 1930  
doug.norton@cbre.com

### ROBBIE TAYLOR

Senior Vice President  
Lic. 01946325  
T +1 408 453 7489  
C +1 408 218 0525  
robbie.taylor2@cbre.com

### MIKE NORTON

Associate  
Lic. 02030025  
T +1 949 725 8522  
C +1 925 360 7947  
mike.norton@cbre.com